

The Pennington

4365 Square Feet

Total Width: 61'-4"
Total Depth: 69'-6"



Version 1
Stone/Shakes/Siding

Base First Floor
2332 Square Feet
(reflects Version 4)

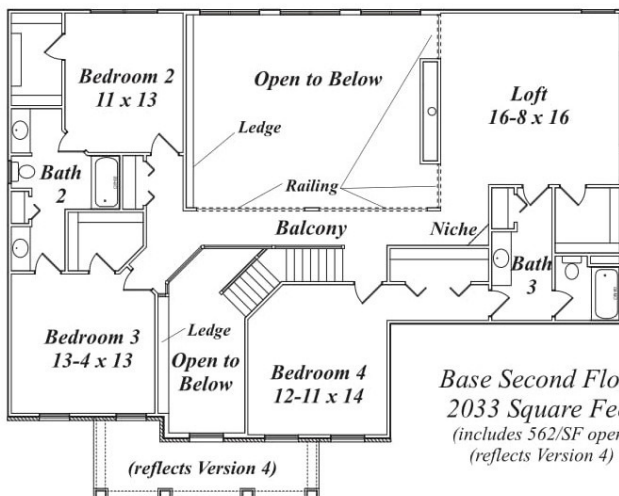
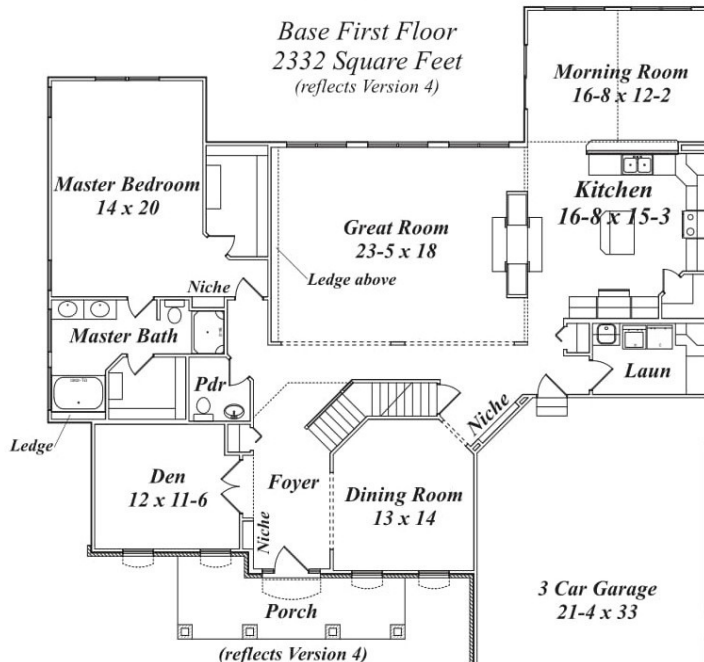

Base Second Floor
2033 Square Feet
(includes 562/SF open)
(reflects Version 4)

First Floor Master

4 Bedrooms
3 1/2 Baths

Features

9' first floor ceilings

Two story center great room design with balcony

First floor master suite with 2 walk-in closets

Formal dining room & den - large kitchen & morning room

Three additional large bedrooms & loft on second floor

Three full baths & one half bath



Office/Model Home:

10532 Cleveland Avenue NW
Uniontown, OH 44685
330-704-2174

www.dutchlegacyhomes.com

This brochure is for illustrative purposes only and is not part of any legally binding contract. Due to continually updated building codes and design improvements, dimensions may vary slightly. See sales associate for current floor plan dimensions.

Note: This plan is copyrighted by Dutch Legacy Homes. Federal copyright law prohibits any unauthorized use of this plan or any part thereof. Violators of the copyright law are subject to prosecution to the extent of the law.

The Pennington

4365 Square Feet



Office/Model Home:
10532 Cleveland Avenue NW
Uniontown, OH 44685
330-704-2174
dutchlegacyhomes.com



Version 2
Brick/Shakes/Siding



Version 3
Stone/Shakes/Siding



Version 4
Brick/Siding



Version 5
Stone/Shakes/Siding

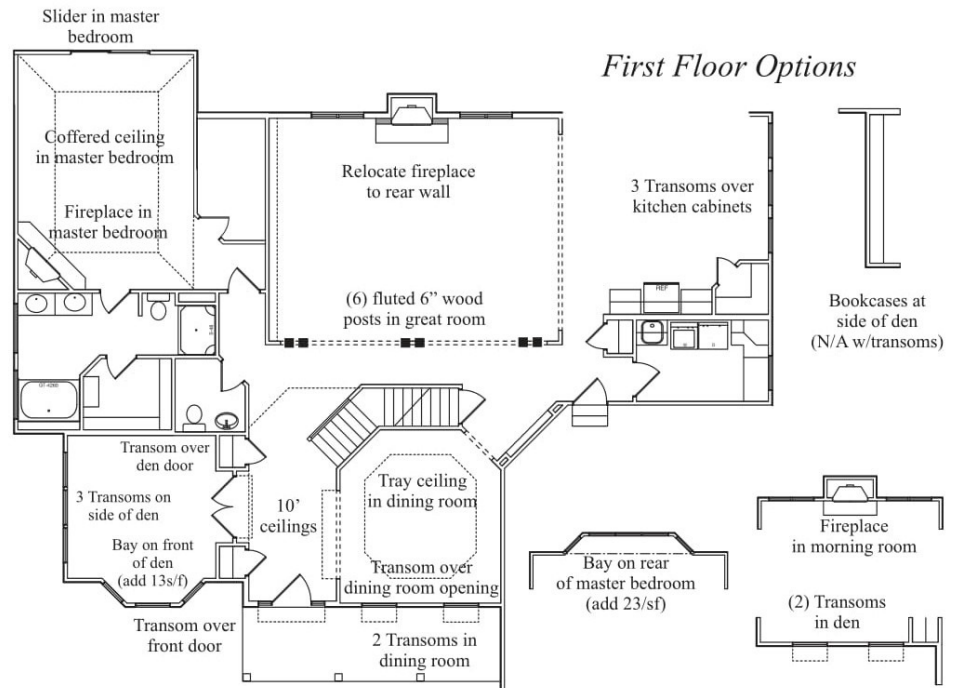

Options

10' ceilings on first floor (includes garage)
Coffered ceiling in master bedroom
Bay on rear of master suite (adds 23 s/f)
Glass cabinets on back side of island in lieu of breakfast bar
Double oven cabinet, cooktop cabinet in island and glass cabinets on back side of island
Wood soffit above island with (3) recessed lights
Drywalled soffit over peninsula with (3) recessed lights
Sliding glass door in master bedroom lieu of (2) windows
(4) transoms in master bedroom (3 with sliding door option)
Sealed, direct vent fireplace in master suite (mantle height stone surround)
(10) drywalled arches (4 are on second floor)
(6) fluted, 6" wood columns at great room
Direct vent fireplace in morning room
Move fireplace to rear wall (credit (4) windows) - shows (2) openings into kitchen from great room
(3) transoms over kitchen cabinets (only with 30" high cabinets)
N/A with Elite Line cabinets
(6) transoms over first floor windows in great room
Bookcases on side of den (includes (4) recessed lights and (8) outlets (N/A with transom option)

(3) transoms on side of den (N/A with bookcase option)
Tray ceiling in dining room
Transom over dining room opening at foyer
Transom over den doors
Bay on front of den (adds 13 s/f) (version 1, 3, and 5 only)
Transom over front door (N/A with Version 4)
(2) transoms over dining room windows (N/A with Version 2 or 4)
(2) transoms over den windows (N/A with bay) (N/A with Version 2 or 4)
(7) transoms in morning room
Arches at front porch headers - (4) on versions 1 and 5 -OR-
(3) on version 2
Electronics cabinet flanking fireplace (moves fireplace 4" into great room)
Built in bookshelf flanking fireplace
Arched drywalled niche above fireplace in great room
(Marble (or tile) toe kick on marble (or tile) fireplace in lieu of wood
Volute bottom stair tread
Open treads and risers (stringers) on first (6) stairs
9' second floor ceilings
Convert loft into Bedroom 5
Convert loft into second master suite
Additional sink in bath 3
Built-in desk in loft (N/A with bedroom options)
Built-in bookcases in loft
Direct vent fireplace in loft

